

INSTALLATION INSTRUCTIONS FOR 8400N SERIES & F8400N PANIC VERTICAL ROD EXIT DEVICE

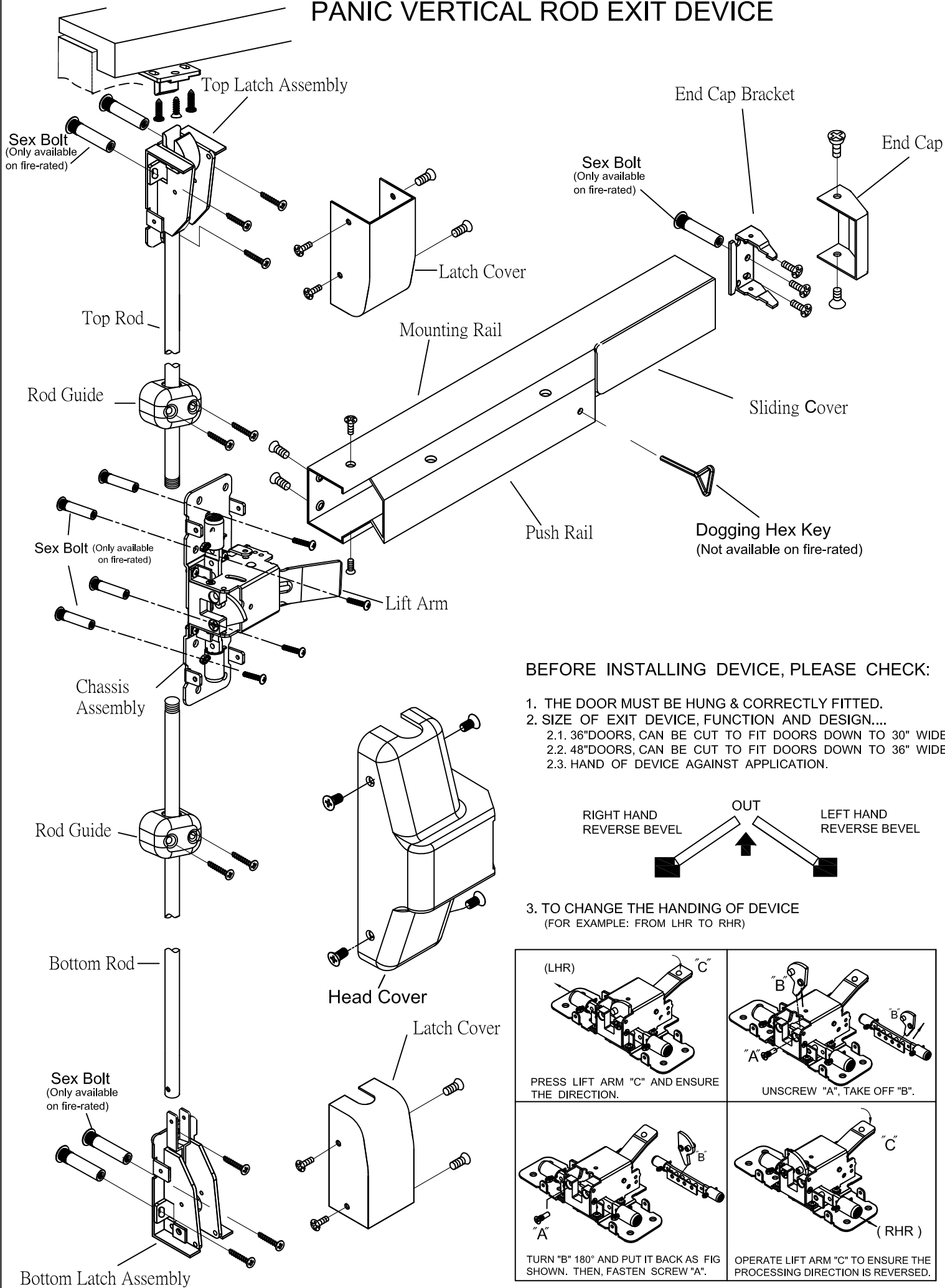

1. MARK VERTICAL AND HORIZONTAL REFERENCE LINE ON DOOR.

DETERMINE BACKSET TO LOCATE VERTICAL REFERENCE LINE.

- A. IF LOCK STILE IS 4 1/2" WIDE OR WIDER, BACKSET IS 2 3/4".
 B. IF LOCK STILE IS LESS THAN 4 1/2" WIDE, BACKSET IS HALF OF THE EXPOSED WIDTH OF LOCK STILE.

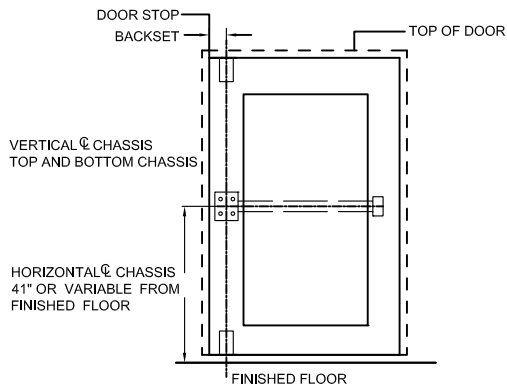

2. PREPARE DOOR

TAPE TEMPLATE ON INSIDE OF DOOR ALONG REFERENCE LINE AND DRILL HOLE.

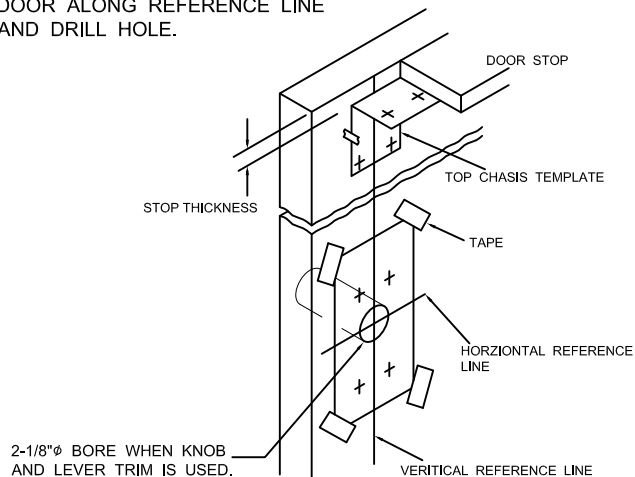

3. INSTALL TRIM / CYLINDER

A. Trim installation: Lever Trim, Knob Trim, Pull Trim, Escutcheon Lever Trim & Thumb piece Pull Trim are optional & all available.

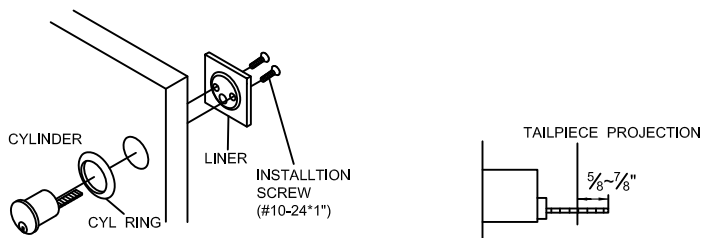
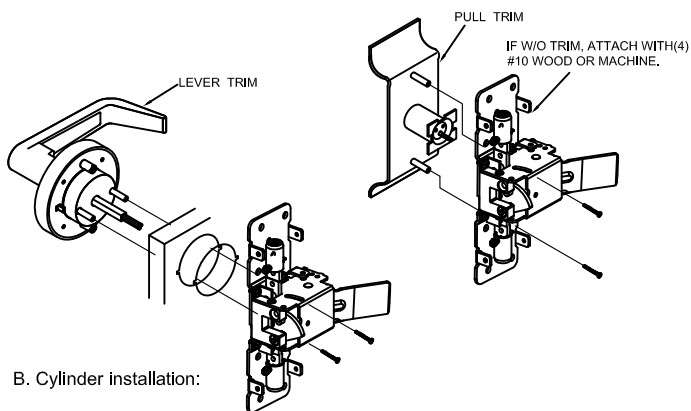

4. ATTACH TOP AND BOTTOM CHASSIS

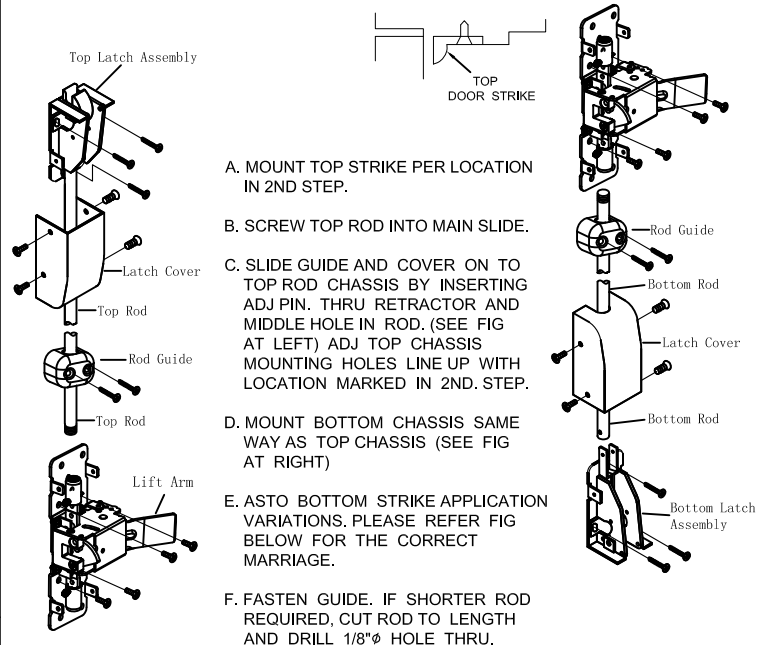

5. APPLY RAIL ASSEMBLY

- A. CHECK THE SIZE OF DEVICE IF CUTTING THE LENGTH IS REQUIRED.
 B. DETERMINE CUT-OFF-LENGTH "X" BY SUBTRACTING 1 3/4" FROM "Y". MARK CUT-OFF-POINT ON MOUNTING RAIL.

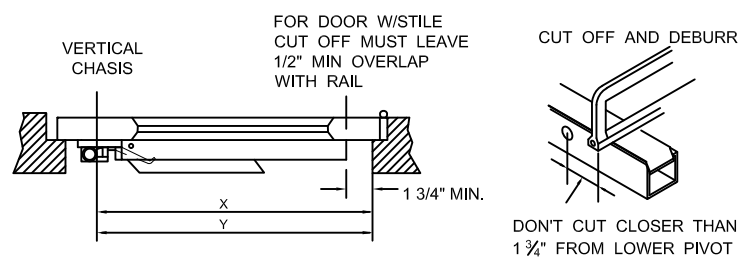

- C. DREPRESS ARM INTO RAIL OPENING AND SLIDE RAIL ONTO CHASSIS. LEVEL RAIL AND FASTEN CHASSIS AND MOUNTING PLATE.

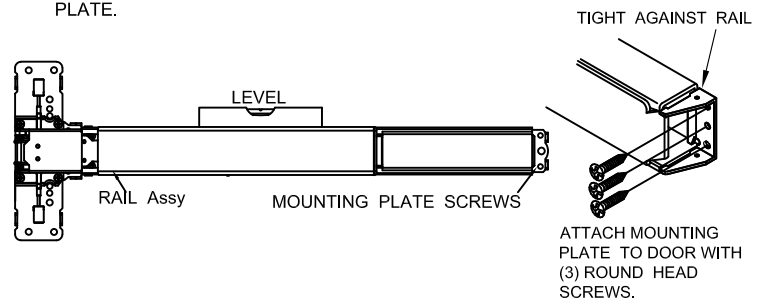

6. APPLY COVERS:

CHECK OPERATION OF DEVICE IS WELL PROCEEDED, AND FASTEN COVERS WITH SCREWS AS BELOW.

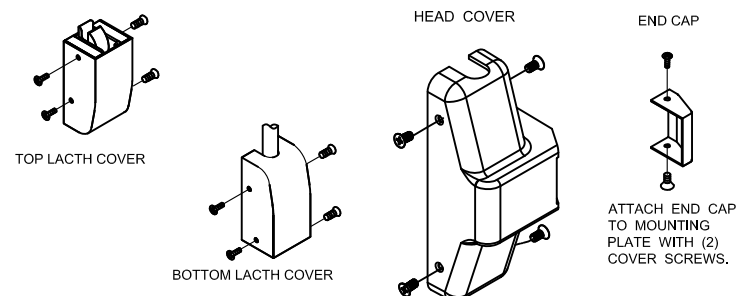

TEMPLATE

OF SVR EXIT DEVICE (1:1)

BACKSET
 [STANDARD 2 1/4" (57.2mm).
 IF THE OVER-LAPPING STRIKE IS NEEDED,
 SEE IT'S TEMPLATE]

1 1/16" (17.6mm)

1 1/16" (17.6mm)

FOR SEX BOLT, DRILL
 3/8" (9.6mm) HOLE OUTSIDE

FOR LEVER TRIM VERTICAL
 THRU-BOLT MOUNTING

FOR EXTERIOR ACCESS BY
 LEVER/KNOB TRIM DRILL
 2 1/8" (54mm) DIA. HOLE

FOR EXTERIOR ACCESS BY
 RIM CYLINDER DRILL
 1 1/4" (31.8mm) DIA. HOLE

(LHR)

7/8" (22mm)

4 1/4" (108mm)

2 3/4" (70mm)

3 1/2" (89mm)

41" (1041mm) FROM
 FINISHED FLOOR
 TO CENTER LINE
 OF PUSH RAIL

(RHR)

FOR EXTERIOR ACCESS BY
 RIM CYLINDER DRILL
 31.8mm (1 1/4") DIA. HOLE

45/64" (17.9mm)

41" (1041mm) FROM
 FINISHED FLOOR
 TO CENTER LINE
 OF PUSH RAIL

For Security Plate

DO NOT drill these two(2) holes on door, if the outside
 trim is not needed to be fixed by them.

15/32" (12mm)

7/8" (22mm)

7/16" (11.1mm)*2

CL of Top Rod & Bottom Rod

LHR

RHR

TEMPLATE of Bottom LATCH (1:1)

【Handicap Strike (Optional use)】

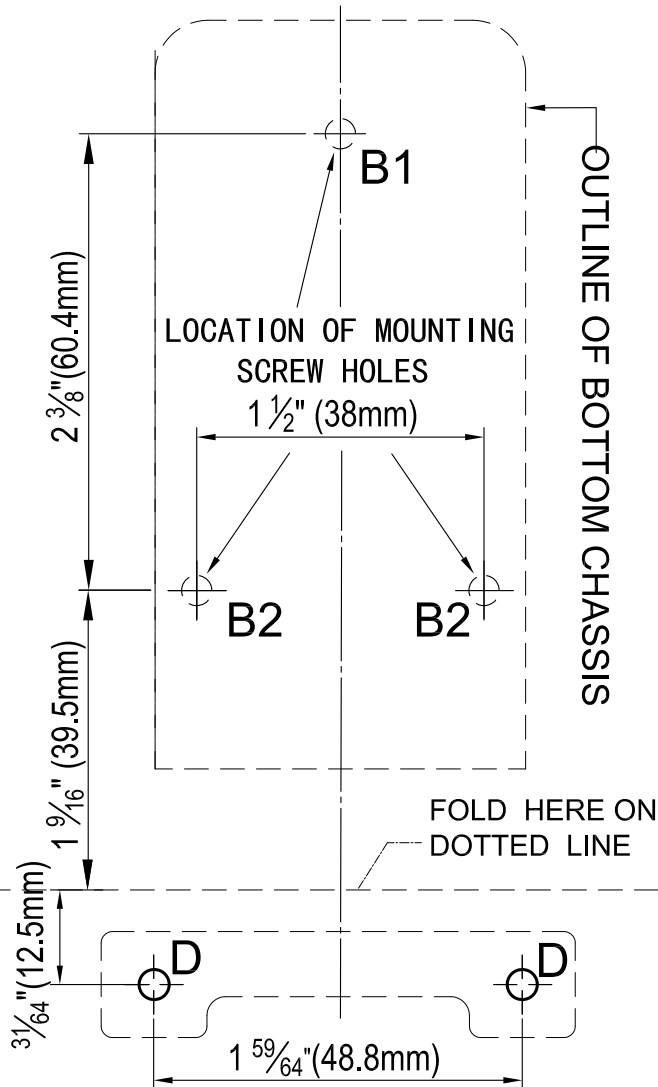
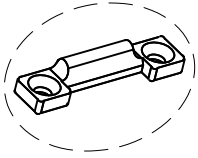

TEMPLATE of Bottom LATCH (1:1)

【Surface Strike (regular use)】

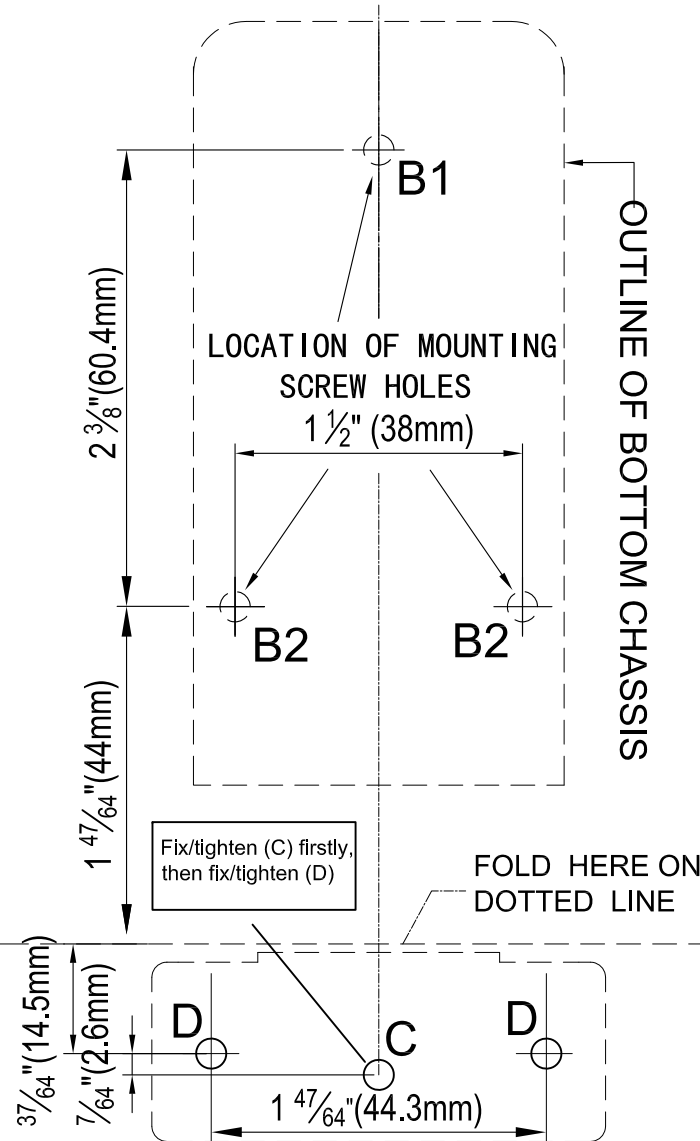
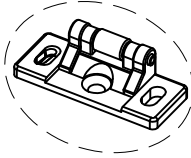

TEMPLATE of Top LATCH (1:1)

【Top Strike (regular use)】

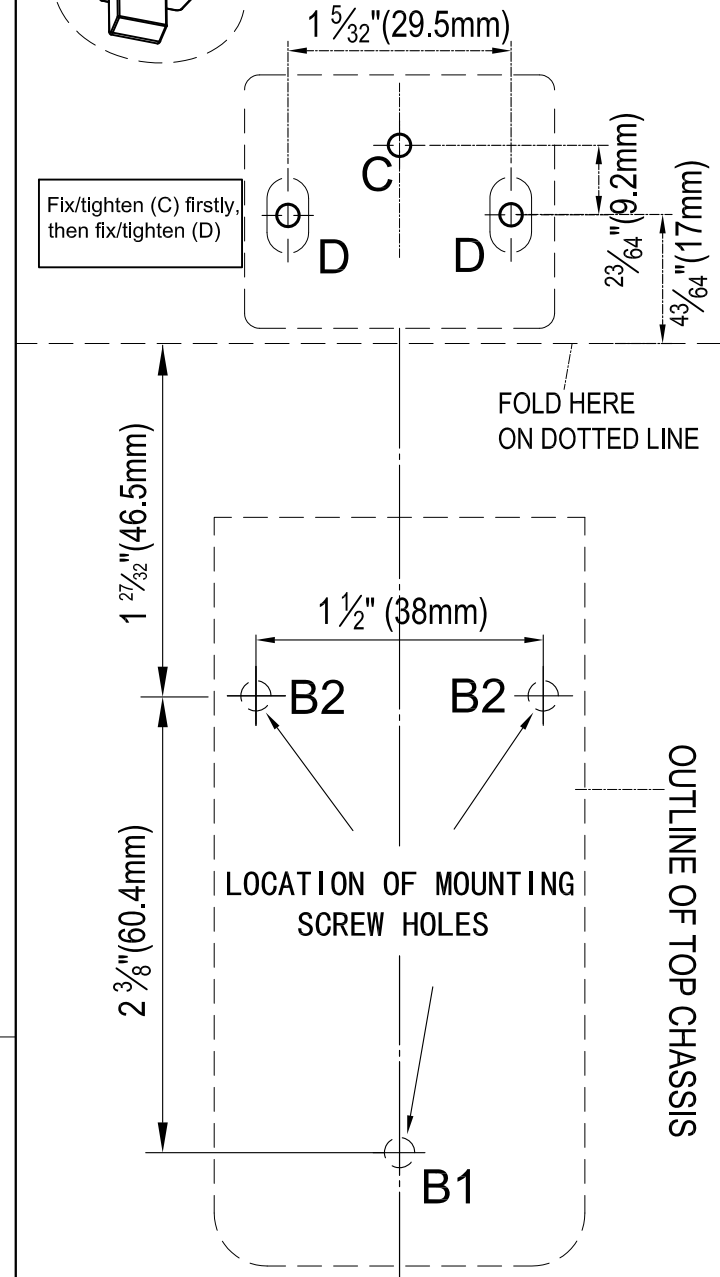
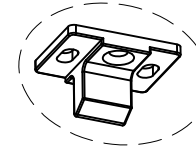

TEMPLATE of Bottom LATCH (1:1)

【Mortise in Strike (Optional use)】

