



# MORTISE & RIM CYLINDERS



## Mortise Cylinder

- Machined from solid brass or bronze bar stock. Six pin SCC cylinder standard. Contact customer service for competitive keyway availability. Available in 15/16", 1-1/8" and 1-1/4" lengths. Contact Customer service for other lengths. See price list for optional cams available.



## IC Mortise Cylinder

- Machined from solid brass or bronze bar stock. Security set screw provided that holds cylinder securely in the housing. Compatible with Best small format 6 or 7 pin cores. Available in 1-1/8" and 1-1/4" lengths. Contact Customer service for other lengths. See price list for optional cams available.



## Dummy Mortise Cylinder

- Machined from solid brass or bronze bar stock. Available only in 15/16" length.



## Thumbpiece Mortise Cylinder

- Machined from solid brass or bronze bar stock. Available in 15/16", 1-1/8" and 1-1/4" lengths. See price list for optional cams available.

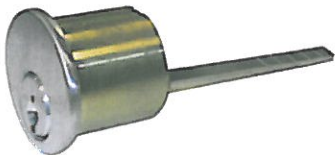

## Rim Cylinder

- Machined from solid brass or bronze bar stock. Six pin SCC cylinder standard. Contact customer service for competitive keyway availability.

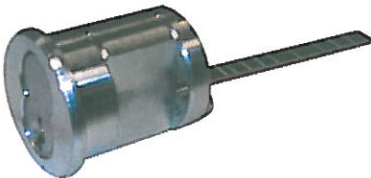

## IC Rim Cylinder

- Machined from solid brass or bronze bar stock. Compatible with Best small format 6 or 7 pin cores.