

# LC2400 SERIES

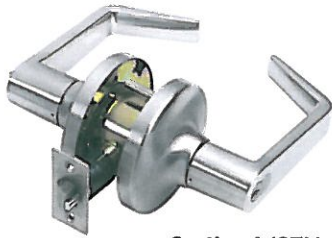

## Heavy-Duty Cylindrical Grade 2 Leversets



Cortland (CTL)



Buckingham (BUC)

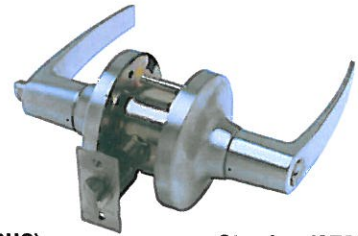

Sturdee (STR)

### Standard Features

- **Performance** Complies with ANSI A156.2, Series 4000, Grade 2, (400,000 cycles), UL listed for 3 hour fire door ANSI A117.1 American Disabilities Act (ADA)
- **Chassis** Cylindrical, steel - coated with zinc dichromate (corrosion resistance), freewheeling clutch (added security from hammer attacks), independent spring cages
- **Lever** Non-handed, solid cast
- **Latch** 1-1/8" x 2-1/4", square corner faceplate, 1" housing diameter (stainless steel), 1/2" throw
- **Rose** 3-1/2" diameter
- **Thru-bolts** Thru-bolts standard. Removable available.
- **Backset** 2-3/4"
- **Strike** Square corner 1-1/4" x 4-7/8" ANSI **ASA Strike**
- **Standard Cylinder** Standard cylinder Schlage (SCC) - 6-pin solid brass, C keyway, keyed different (KD).
- **Keys** Two nickel silver per lock cylinder
- **Cylinder** Other manufacturers including small format interchangeable cores
- **Door Range** 1-3/8" - 2"
- **Door Preparation** 2-1/8" diameter for lever, 1" diameter for latchbolt. Fits standard 161 door prep with through-bolting through the door.
- **Warranty** 1 year limited

### Optional Features

- **Strike** **T Strike** (1-1/8" x 2-3/4"), and **F Strike** (full lip)
- **Backset** 2-3/8"

### Keying Options

- **Tell Cylinder** Restricted Tell keyway cylinder can key both the cylinder and interchangeable core in one lock. The cylinders and IC cores are interchangeable. Tell keyway cylinder is available **only** keyed to 6-pin. Tell IC cylinder can be keyed to 6-pin or 7-pin interchangeable core (IC).
- **Other Cylinder Options** Arrow A (ARA), Corbin 59A1 (C059A1), Corbin 60 (C06), Corbin Russwin L4 (CL4), Kwikset (KW1), Russwin D1 (RD1), Sargent LA (SAL), Schlage E (SCE), Schlage F (SCF), Weiser E (WRE), Yale 8 (YA8), Yale GA (YGA)  
**ALL CYLINDERS 6-PIN. CAN ALSO BE PINNED 5-PIN.**
- **IC Keyway Cylinder** Tell, Best A (BA), Best B (BB), Best C (BC), Best D (BD), Best E (BE), Best F (BF), Best G (BG), Best H (BH), Best J (BJ), Best K (BK), Best L (BL), Best M (BM), Best Q (BQ), Best U (BU), Black construction core (BLK), Less core (00), Not specified (XX)  
**AVAILABLE 6- OR 7-PIN**
- **Keying Options** Grand master key (GMK), construction master key (CMK), master key (MK), keyed different (KD), keyed alike (KA), interchangeable core uncombined (IC), 0-bitted (0BIT)



# LC2400 Series Function Chart

FUNCTION	FUNCTION NO.	OUTSIDE	INSIDE	FUNCTION DESCRIPTION	ANSI NO.
Entrance	81			<ul style="list-style-type: none"> <li>Latchbolt operated by lever from either side</li> <li>Outside lever locked by push button from inside</li> <li>Unlocked by key from outside or rotating inside lever</li> <li>When outside lever locked by push and turn button from inside, key from outside or rotating inside lever retracts latch, does not unlock outside lever</li> </ul>	F81
Office	82			<ul style="list-style-type: none"> <li>Deadlocking latch bolt operated by lever from either side except when outside lever is locked by push button or other locking device on inside. When outside lever is locked, operating key in outside lever or operating inside lever unlocks push button or other locking device and retracts latch bolt. Closing door does not release push button or other locking device.</li> </ul>	
Classroom	84			<ul style="list-style-type: none"> <li>Latchbolt operated by lever from each side</li> <li>Outside lever locked or unlocked by key from outside</li> <li>Inside lever always operates latch</li> </ul>	F84
Storeroom	86			<ul style="list-style-type: none"> <li>Latch operated by rotating inside lever or key in outside lever</li> <li>Outside lever always fixed</li> </ul>	F86
Apartment or Exit	91			<ul style="list-style-type: none"> <li>For office or apartment building entrance doors or lavatory doors</li> <li>Deadlocking latchbolt</li> <li>Either lever operates latchbolt</li> <li>Key in outside lever operates latchbolt</li> <li>Should be used only in offices or rooms with multiple entries</li> </ul>	F88
Privacy Bedroom/Bathroom	76			<ul style="list-style-type: none"> <li>Latchbolt operated by lever from either side</li> <li>Outside lever locked by push button on inside</li> <li>Unlocked by emergency release on outside, rotating inside lever, or closing door</li> </ul>	F76
Passage Hall/Closet	75			<ul style="list-style-type: none"> <li>Latchbolt operated by lever from either side at all times</li> </ul>	F75
Communicating	80			<ul style="list-style-type: none"> <li>Latchbolt operated by lever from one side at all times</li> </ul>	F80
Single Dummy	01			<ul style="list-style-type: none"> <li>Pull lever one side</li> <li>No mechanical operation</li> </ul>	

# ACCESSORIES

## LC2400 Series Latches



**CL100193** —  
2-3/4" Guarded, US26D

**CL100194** —  
2-3/4" Unguarded, US26D

**CL100195** —  
2-3/8" Unguarded, US26D

**CL100518** —  
2-3/8" Guarded, US26D

Drive-in latch, used where face plate not required available in 2-3/8" and 2-3/4" backset. 1/2" throw, 1" diameter body.



**CL100214** —  
2-3/4" Unguarded, US32D

**CL100216** —  
2-3/8" Unguarded, US32D

**CL100210** —  
2-3/4" Unguarded, US3

**CL100211** —  
2-3/8" Unguarded, US3

UL listed latch bolt with non-deadlatching function. 1/2" throw. 2-3/8" and 2-3/4" backset available. Fits 160 door prep (2-1/8" hole, 7/8" latch hole) or fits 161 door prep (2-1/8" hole, 1" latch hole).



**CL100213** —  
2-3/4" Guarded, US32D

**CL100212** —  
2-3/8" Guarded, US32D

**CL100209** —  
2-3/4" Guarded, US3

**CL100251** —  
2-3/8" Guarded, US3

UL listed latch bolt with deadlatching function. 1/2" throw. 2-3/8" and 2-3/4" backset available. Fits 160 door prep (2-1/8" hole, 7/8" latch hole) or fits 161 door prep (2-1/8" hole, 1" latch hole).



## LC2400 Series Strikes

**CL100186** — ASA Strike, US32D

**CL100187** — ASA Strike, US3

**CL100415** — ASA Strike, US10B

For metal frames. (1-1/4" x 4-7/8" x 3/32").



**CL100191** — T Strike, US32D

**CL100189** — T Strike, US3

**CL100420** — T Strike, US10B

For wood frames. (1-1/8" x 2-3/4" x 3/32").



**CL100190** — F Strike, US32D

**CL100192** — F Strike, US3

**CL100581** — F Strike, US10B

For wood residential applications. (1-5/8" x 2-1/4" x 3/32").



## LC2400 Series Non-Restricted Keyway

**CL100219** —  
Cylinder, Schlage C,  
US26D

**CL100584** —  
Cylinder, Schlage C,  
US4

Standard brass 6-pin cylinder SCC keyway, optional keyways available (see price list).



**CL100268** —  
IC Core Best A 6 Pin, US26D

**CL100270** —  
IC Core Best A 7 Pin, US26D

**CL100269** —  
IC Core Best A 6 Pin, US4

**CL100271** —  
IC Core Best A 7 Pin, US4

Small format interchangeable core brass cylinder 6-pin standard, 7-pin available. Best "A" keyway standard.



## LC2400 Series Tell Restricted Keyway

### TELL CYLINDERS:

**CL101503** —  
6 pin Tell cylinder, US26D

**CL101504** —  
6 pin Tell cylinder, US4



### TELL INTERCHANGEABLE CORES:

**CL101499** — 6 pin Tell IC core, US26D

**CL101500** — 6 pin Tell IC core, US4

**CL101501** — 7 pin Tell IC core, US26D

**CL101502** — 7 pin Tell IC core, US4



**FINISHES:** US32D=Satin Stainless Steel, US3=Bright Brass, US26D=Satin Chrome, US4=Satin Brass, US10B=Oil Rubbed Bronze

**TELL MANUFACTURING, INC** — Page 31 — 2012

**CORPORATE OFFICE:** 18 Richard Drive, Lititz, PA 17543 **TOLL FREE:** 800-433-4047 **PHONE:** 717-625-2990 **FAX:** 717-625-7095

**OTHER LOCATIONS:** HOUSTON, TEXAS ELKHART, INDIANA MIRA LOMA, CALIFORNIA

**WEBSITE:** www.tellmfg.com



# How to Order LC2400 Series

IC KEYWAY CYLINDER\*  
AVAILABLE 6- or 7-PIN

- TELL — Tell
- XX — Not Specified
- 00 — Less Core
- BLK — Black Construction Core
- BU — Best U
- BQ — Best Q
- BM — Best M
- BL — Best L
- BK — Best K
- BJ — Best J
- BH — Best H
- BG — Best G
- BF — Best F
- BE — Best E
- BD — Best D
- BC — Best C
- BB — Best B
- BA — Best A

- KEYING
- 0BIT — 0-Bitted
  - IC — Interchangeable Core Uncombined
  - KA — Keyed Alike
  - KD — Keyed Different
  - MK — Master Key
  - CMK — Construction Master Key
  - GMK — Grand Master Key

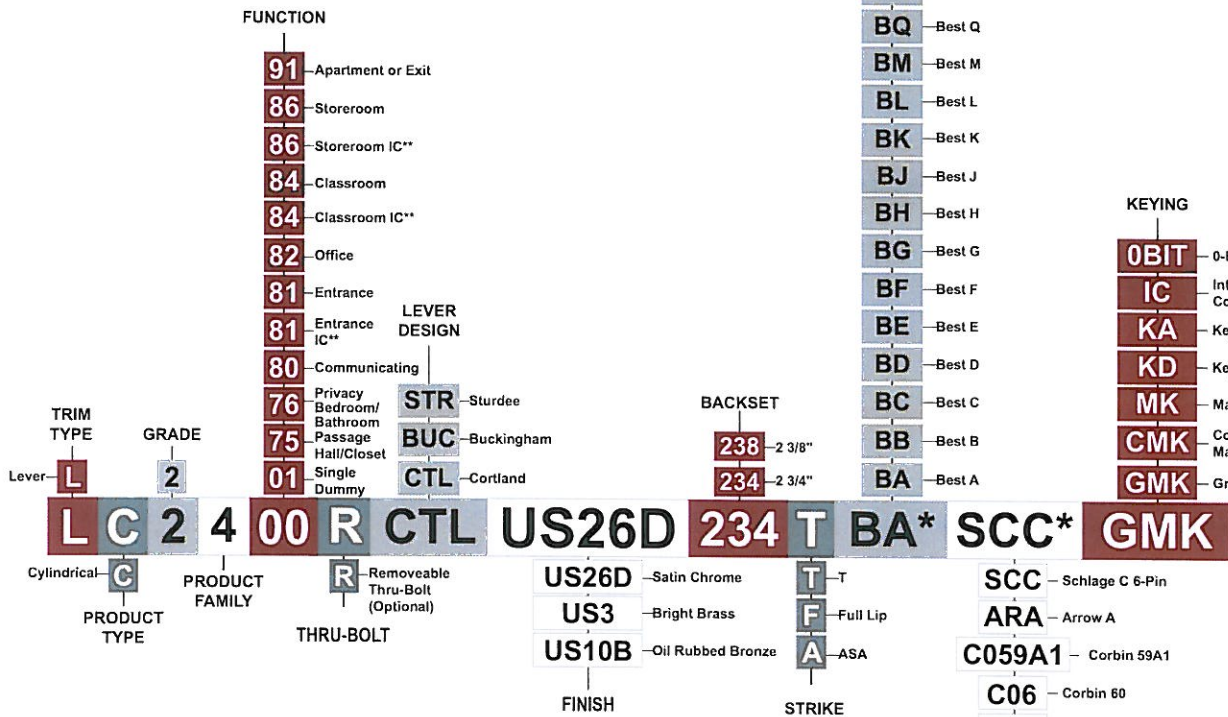

- SCC — Schlage C 6-Pin
- ARA — Arrow A
- C059A1 — Corbin 59A1
- C06 — Corbin 60
- CL4 — Corbin Russwin L4
- KWI — Kwikset KW1
- RD1 — Russwin D1
- SAL — Sargent LA
- SCE — Schlage E
- SCF — Schlage F
- WRE — Weiser E
- YA8 — Yale 8
- YGA — Yale GA
- TELL — Tell

NON-IC KEYWAY CYLINDER\*

ALL CYLINDERS AVAILABLE 6-PIN. CAN ALSO BE PINNED 5-PIN.  
TELL KEYWAY CYLINDER IS AVAILABLE ONLY KEYED TO 6-PIN.

\* Choose one keyway format; either IC KEYWAY CYLINDER or Non-IC KEYWAY CYLINDER  
\*\* IC functions in Satin Chrome (26D) only